

ACCESS PANEL

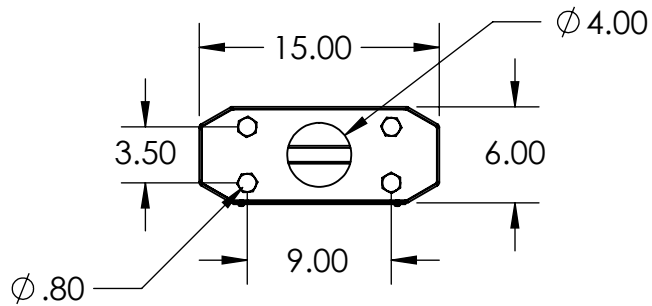

NOTES:

1. MATERIAL OF CONSTRUCTION IS ALUMINUM.
2. COATED IN 2-4 MILS GLOSS BLUE POWDER COATING.

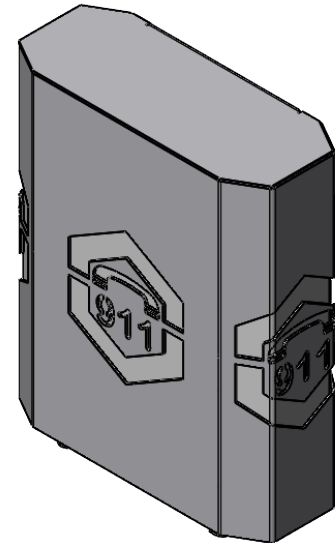

PEDESTALPRO.COM
1-800-660-3072

UNLESS OTHERWISE SPECIFIED:

DIMENSIONS ARE IN INCHES
TOLERANCES:
FRACTIONAL $\pm 1/32$
ANGULAR: $\pm 2^\circ$
TWO PLACE DECIMAL ± 0.010
THREE PLACE DECIMAL ± 0.005

INTERPRET GEOMETRIC
TOLERANCING PER:
ASME Y14.5 -2009

NAME	DATE
DRAWN	
CHECKED	

PROPRIETARY AND CONFIDENTIAL

THE INFORMATION CONTAINED IN THIS
DRAWING IS THE SOLE PROPERTY OF
PEDESTALPRO LLC. ANY REPRODUCTION
IN PART OR AS A WHOLE WITHOUT THE
WRITTEN PERMISSION OF PEDESTALPRO LLC
IS PROHIBITED.

TITLE:

INSTALLATION

Wednesday, April 27,
2022 11:22:56 AM

WEIGHT: 14.911

SIZE
A

PART NO.
156TOW-EMER-02-ALU

REV
A

NO SCALE

SHEET 1 OF 9

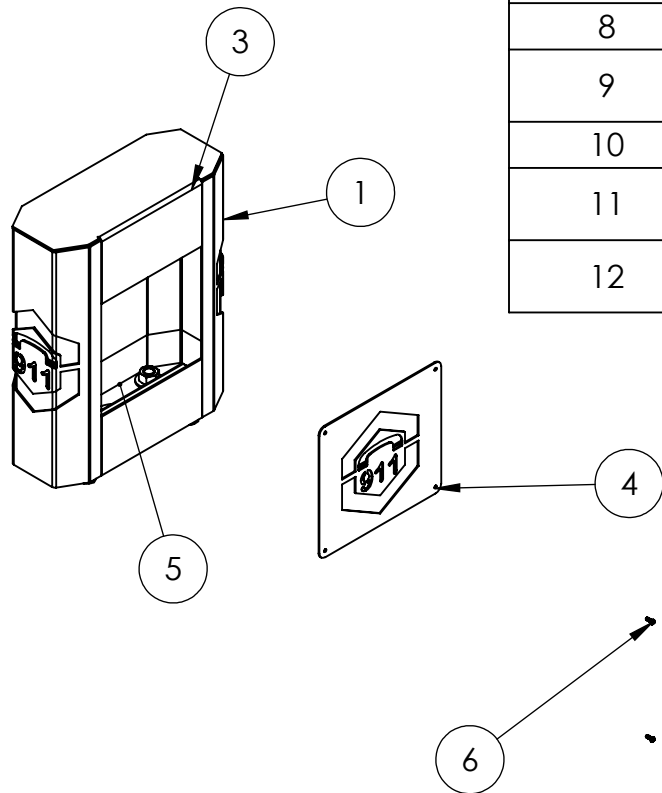

ITEM NO.	PART NUMBER	DESCRIPTION	QTY.
1	156TOW-EMER-02-ALU BODY	ALUM BODY	1
2	156TOW-EMER-02-ALU CLOSURE	CLOSURE PANEL	1
3	156TOW-EMER-02-ALU CAP	TOP CAP	1
4	156TOW-EMER-02-ALU ACCESS	ACCESS PANEL	1
5	156TOW-EMER-02-ALU BASE	BASE PLATE	1
6	--	8-32 X 1/2" PAN HEAD SCREW	4
7	156TOW-EMER-02-ALU LIGHT	LIGHTING BRACKET	2
8	--	18-8 STAINLESS STEEL WASHER	4
9	--	18-8 STAINLESS STEEL HEX HEAD SCREW	4
10	--	18-8 STAINLESS STEEL HEX NUT	4
11	156TOW-EMER-02-ALU ACRYLIC	ACRYLIC DIFFUSER	1
12	156TOW-EMER-02-ALU ACRYLIC 2	ACRYLIC DIFFUSER	1

NOTES:

1. SEE STANDARD PREPARATION AND COATING INSTRUCTIONS FOR COATING PROCEDURE AND COLOR.
2. SEE STANDARD PACKAGING INSTRUCTIONS FOR PACKAGING PROCEDURE.



PEDESTALPRO.COM
1-800-660-3072

UNLESS OTHERWISE SPECIFIED:

DIMENSIONS ARE IN INCHES
TOLERANCES:
FRACTIONAL $\pm 1/32$
ANGULAR: $\pm 2^\circ$
TWO PLACE DECIMAL ± 0.010
THREE PLACE DECIMAL ± 0.005

INTERPRET GEOMETRIC
TOLERANCING PER:
ASME Y14.5 -2009

NAME	DATE
DRAWN	
CHECKED	

PROPRIETARY AND CONFIDENTIAL

THE INFORMATION CONTAINED IN THIS
DRAWING IS THE SOLE PROPERTY OF
PEDESTALPRO LLC. ANY REPRODUCTION
IN PART OR AS A WHOLE WITHOUT THE
WRITTEN PERMISSION OF PEDESTALPRO LLC
IS PROHIBITED.

TITLE:

ASSEMBLY

Wednesday, April 27,
2022 11:25:00 AM

WEIGHT: 14.911

SIZE
A

PART NO.
156TOW-EMER-02-ALU

REV
A

NO SCALE

SHEET 2 OF 9