

## QuickPort® In-Wall Bracket

For use with NEMA-style electrical / low-voltage boxes and mud rings

### APPLICATION

The QuickPort In-Wall Bracket provides the ability to create a testable permanent link for cabling that terminates in the wall without the use of a traditional wallplate. It is ideal for Ethernet-enabled devices that mount to electrical/low-voltage boxes or directly to the wall surface, such as WAPs, cameras, or clocks. The bracket provides a stable mounting surface for the connector that is recessed behind the wall. It allows for a cabling design that is ANSI/TIA-568-C compliant. Device connections from the recessed connector are easily made with Leviton High-Flex HD6 patch cords.

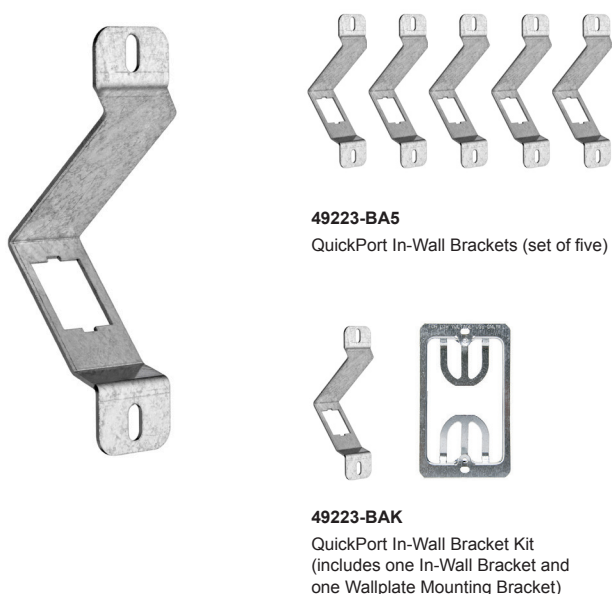

### SPECIFICATION

Bracket shall provide the ability to create a testable permanent link for cabling that terminates in the wall without the use of a traditional wallplate. It shall provide a fixed location for the connector after termination, reducing the potential for damage prior to device installation. Bracket shall be compatible with standard NEMA electrical boxes and rings having a device mounting hole spacing of 3-9/32 inches. Ethernet-enabled devices shall be able to mount to the NEMA opening even with the adapter in place.

### FEATURES

- Allows for ANSI/TIA-568-C compliant cabling design
- Provides the ability to create a testable permanent link for cabling that terminates in the wall without the use of a traditional wallplate
- Creates a fixed location for the connector after termination, reducing the potential for damage prior to device installation
- Provides ability to test and warrant the cabling using the same equipment and process as any other work area outlet connector
- Available as a set of 5 brackets, or individually kitted with a single-gang low-voltage Leviton Wallplate Mounting Bracket

### DESIGN CONSIDERATIONS

- Bracket is designed to mount in standard NEMA electrical device opening with 3-9/32 inch [83.34 mm] hole spacing
- #8/32 mounting screws included with each bracket
- To ensure proper cable bend radius, a 4"x4" box with reducer ring is recommended; consider using a 5"x5" box for Cat 6A cabling
- Leviton High-Flex HD6 patch cords (6H460-xxx) have a 0.15" OD, resulting in a smaller minimum bend radius, and are available in multiple lengths starting at 6 inches.

### PHYSICAL SPECIFICATIONS

Dimensions: see page two

Materials: 16-gauge galvanized steel (In-Wall Bracket)  
22-gauge galvanized steel (Wallplate Mounting Bracket)

### STANDARDS COMPLIANCE

ANSI/TIA-568-C compliant

### COUNTRY OF ORIGIN

Mexico

### WARRANTY INFORMATION

For a copy of Leviton product warranties, visit [www.leviton.com/warranty](http://www.leviton.com/warranty)

49223-BA5, 49223-BAK

ELECTRONIC FILES

For CAD files, typical specs, or technical drawings (.DXF, .DWG), visit [www.leviton.com](http://www.leviton.com).

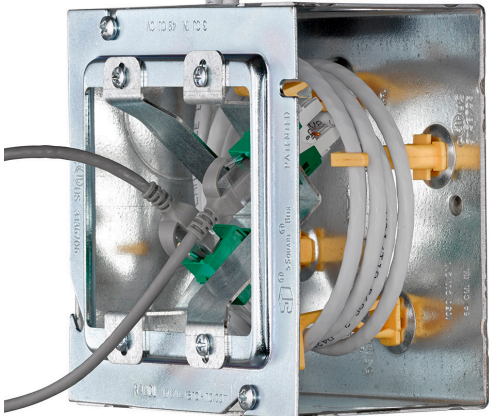
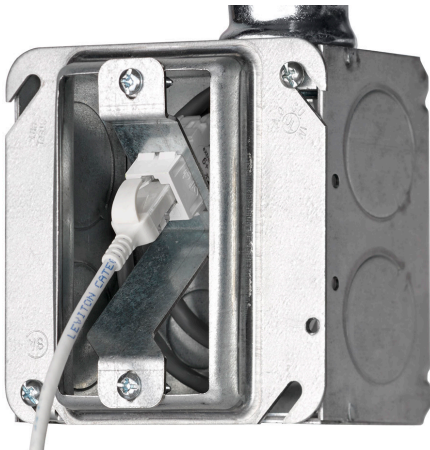
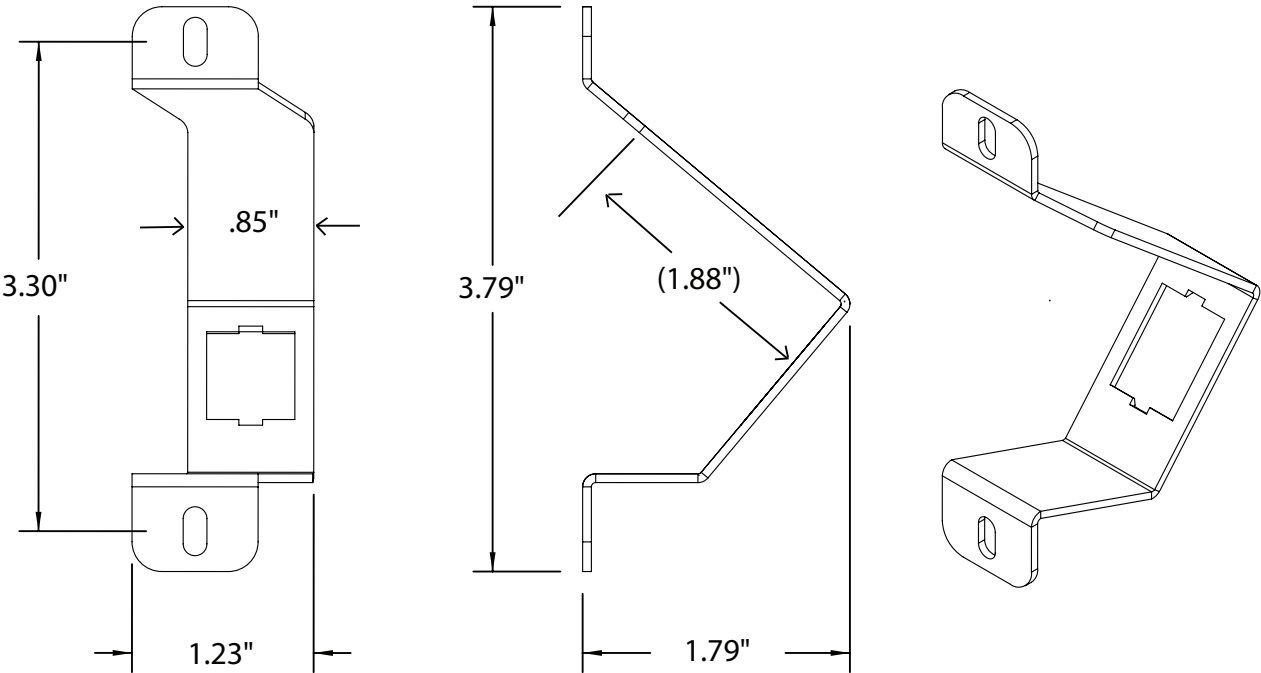

PART NUMBERS

Description

Part No.

QuickPort® In-Wall Brackets, set of 5 49223-BA5

QuickPort In-Wall Bracket Kit, includes In-Wall Bracket and single-gang Wallplate Mounting Bracket 49223-BAK

Leviton Network Solutions  
2222 - 222nd St. SE  
Bothell, WA 98021-4416

tel 1-800-824-3005  
tel +1-425-486-2222  
[appeng@leviton.com](mailto:appeng@leviton.com)  
[www.leviton.com](http://www.leviton.com)

Asia / Pacific  
T +1.631.812.6228  
E [infoasean@leviton.com](mailto:infoasean@leviton.com)

Europe  
T +44.0.1592.772124  
E [customerserviceeu@leviton.com](mailto:customerserviceeu@leviton.com)

Canada  
T +1.514.954.1840  
E [pcservice@leviton.com](mailto:pcservice@leviton.com)

Mexico  
T +52.55.5082.1040  
E [lsamarketing@leviton.com](mailto:lsamarketing@leviton.com)

Caribbean  
T +1.954.593.1896  
E [infocaribbean@leviton.com](mailto:infocaribbean@leviton.com)

Middle East & Africa  
T +971.4.247.9800  
E [lmeinfo@leviton.com](mailto:lmeinfo@leviton.com)

China  
T +852.2774.9876  
E [infochina@leviton.com](mailto:infochina@leviton.com)

South Korea  
T +82.2.3273.9963  
E [infokorea@leviton.com](mailto:infokorea@leviton.com)

Colombia  
T +57.1.743.6045  
E [infocolombia@leviton.com](mailto:infocolombia@leviton.com)