

Wetguard® Connectors

(For use with Wetguard® Inlets only)

NEMA & NON-NEMA

IP66 Suitability. Rated to NEMA Type 4, 4X & 12
when mated with Leviton Wetguard® Inlets



PK-93740-10-00-0A

WIRING INSTRUCTIONS

ENGLISH

WARNINGS AND CAUTIONS:

- To be installed and/or used in accordance with appropriate electrical codes and regulations.
- If you are not sure about any part of these instructions, consult an electrician.
- Use this device with **stranded copper wire only**.
- **Non-grounded devices are for connection to non-grounded circuits only.**
- Non-NEMA devices are UL Listed for replacement use only.

NOTE: WIRE SIZE AND TYPE MUST COMPLY WITH APPROPRIATE LOCAL ELECTRICAL CODES. IN USA REFER TO NEC TABLES ARTICLE 400.

TO INSTALL

WARNING: TO AVOID FIRE, SHOCK OR DEATH; **UNPLUG CORD OR TURN OFF POWER** AT CIRCUIT BREAKER OR FUSE AND TEST THAT POWER IS OFF BEFORE WIRING!

1. Select size and type of round cord as per your requirements.
2. Referring to **Fig. 1**, remove nut (1) from rubber housing (3). Separate wiring module (4) from rubber housing by pushing the module from back of housing with a screwdriver (or cord).
3. Select proper size of strain relief washer (10) and rubber bushing (9) per your cord size as per appropriate **table** below, or use the back of the rubber bushing as a gage. *The washers and bushings must be broken apart from each other before use (see Fig. 1).*
4. Feed wiring cord through nut (1), strain relief washer (10), rubber bushing (9) and into threaded insert of housing (3) as shown in **Fig. 1**. **DO NOT REVERSE ORIENTATION OF STRAIN RELIEF WASHER AND RUBBER BUSHING.**
5. Strip cord jacket and conductors as per appropriate **wire stripping gage**, or as per strip gage molded on the back of wiring cover.
6. **Connect wires:** Carefully back out all terminal wiring screws until edge of backwire clamp is not visible in wire well. Twist the strands of each stripped conductor tightly together, and insert into proper wire well. Tighten wiring screw firmly to 12-14 in.-lbs. Torque. **CHECK FOR STRAY WIRE STRANDS.** Repeat for all conductors. **NOTE:** Where applicable it is recommended to connect GROUND wire first.
- CAUTION:** Wiring clamps **MUST** contact on conductor only, **NOT** on insulation.
DO NOT USE SOLID WIRE. DO NOT TIN CONDUCTORS.
7. Reattach the wired module (4) to the housing (3) by aligning key guide (8) on the module to the key on the housing, and tighten the assembly screws firmly to 10-14 in.-lbs. torque.
8. Push up rubber bushing (9) and strain relief washer (10) over cord so that the nut can engage the threaded insert.

IMPORTANT: Rubber housing must be held firmly when tightening nut.

NOTE 1: Use back of rubber bushings as a gage for cable size or appropriate **table** below. Always use matched bushing and strain relief washers.

NOTE 2: **Polarity of wiring for NEMA devices** is identified by markings on device and/or screw color as shown below. For Polarity of wiring for NON-NEMA devices refer to device(s) to be replaced for specific wiring pattern.

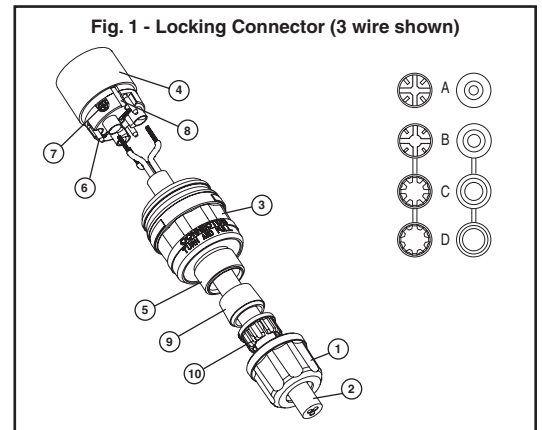

- 1 - Nut
- 2 - Cord
- 3 - Rubber Housing
- 4 - Wiring Module
- 5 - Threaded Insert
- 6 - Assembly Screws
- 7 - Terminal Screws
- 8 - Key Guide on Wiring Module (to be aligned with Key on Housing)
- 9 - Rubber Bushing (select as per Strain Relief Washer)
- 10 - Strain Relief Washer

MARKING ON NEMA DEVICE	NEMA SCREW COLOR	CONDUCTOR COLOR
G, GRND, GREEN, or EQ GR	(Grounding) -- GREEN	Bare, Green, or Green/Yellow wire
W, or WHITE	(Neutral) -- SILVER	White or Gray wire
X,Y,Z or BLANK	(Hot) -- BRASS or BLACK	Black, Red, Blue or any other than White, Green, Gray, Green/Yellow or Bare wire

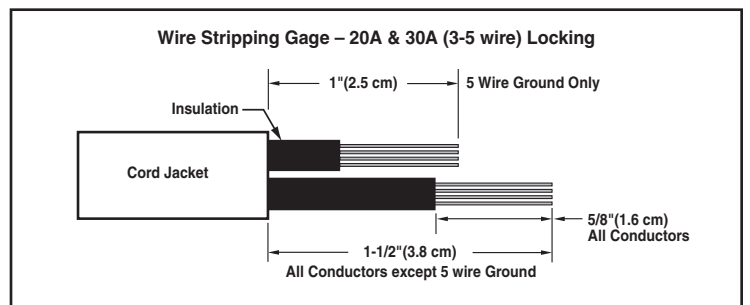
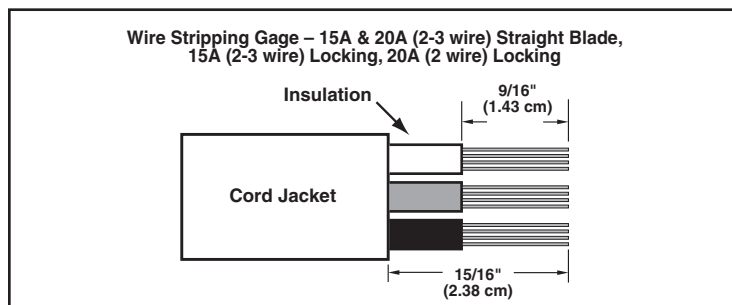

BUSHING AND STRAIN RELIEF CORD SIZING			
Bushing/Washer	Gage (AWG)	Type	Range
15A & 20A (2-3 wire) Straight Blade, 15A (2-3 wire) Locking, 20A (2 wire) Locking			
A	18/2	S, ST, SVT, SO, SOW	.234 - .437
	18/3	S, ST, SO, SOW	
	16/3	S, ST, SO, SOW	
	14/2	SJ	
	14/3	SJ, SJT, SJTO, SJTOW	
B	14/2	S, ST, SO, SOW	.437 - .562
	14/3	S, ST, SO, SOW	
C	12/2	SO, SOW	.562 - .687
	12/3	SO, SOW	
	10/2	SO, SOW	
	10/3	SOW	
20A (3 - 5 wire) Locking			
A	16/3	SO, SOO, ST, STO, SJ, SJO, SJT	.375 - .500
	16/4	SO, SOO, ST, STO, SJ, SJO, SJT	
	14/3	SO, SOO, ST, STO, SJ, SJO, SJT	
	14/4	SO, SOO, ST, STO, SJ, SJO, SJT	
	12/3	SO, SOO, ST, STO, SJ, SJO, SJT	
	12/4	SO, SOO, ST, STO, SJ, SJO, SJT	
B	14/3	SO, SOO, ST, STO	.500 - .625
	14/4	SO, SOO, ST, STO	
	12/3	SO, SOO, ST, STO	
C	14/5	SO, SOO, ST, STO	.625 - .750
	12/4	SO, SOO, ST, STO	
	12/5	SO, SOO, ST, STO	
	10/3	SO, SOO, ST, STO	
D	10/4	SO, SOO, ST, STO	.750 - .875
	10/5	SO, SOO, ST, STO	

BUSHING AND STRAIN RELIEF CORD SIZING			
Bushing/Washer	Gage (AWG)	Type	Range
30A (3 - 5 wire) Locking			
A	12/3	SJ, SJO, SJT, SO, SOO, ST, STO	.625 - .750
	12/4	SJ, SJO, SJT, SO, SOO, ST, STO	
	12/5	SJ, SJO, SJT, SO, SOO, ST, STO	
	10/3	SJ, SJO, SJT, SO, SOO, ST, STO	
	10/4	SJ, SJO, SJT, SO, SOO, ST, STO	
B	10/4	SO, SOO, ST, STO	.750 - .875
	10/5	SO, SOO, ST, STO	
	8/3	SO, SOO, ST, STO	
C	8/4	SO, SOO, ST, STO	.875 - 1.000
D	8/5	SO, SOO, ST, STO	1.000 - 1.125

These products are covered by Patents: US 5,863,221; US 6,017,243; CA 2,243,838; CA 2,266,253; MX 225,136 and MX 215,544.

LIMITED LIFETIME WARRANTY AND EXCLUSIONS

Leviton warrants to the original consumer purchaser and not for the benefit of anyone else that this product at the time of its sale by Leviton is free of defects in materials and workmanship under normal and proper use during the lifetime of the product. Leviton's only obligation is to correct such defects by repair or replacement, at its option, if the product is returned prepaid, with proof of purchase date, and a description of the problem to **Leviton Manufacturing Co., Inc., Att: Quality Assurance Department, 201 North Service Road, Melville, N.Y. 11747**. This warranty excludes and there is disclaimed liability for labor for removal of this product or reinstallation. This warranty is void if this product is installed improperly or in an improper environment, overloaded, misused, opened, abused, or altered in any manner, or is not used under normal operating conditions or not in accordance with any labels or instructions. There are no other or implied warranties of any kind, including merchantability and fitness for a particular purpose. Leviton is not liable for incidental, indirect, special, or consequential damages, including without limitation, damage to, or loss of use of, any equipment, lost sales or profits or delay or failure to perform this warranty obligation. The remedies provided herein are the exclusive remedies under this warranty, whether based on contract, tort or otherwise.