

Installation and Setup Guide

General

The Communication Module uses an internal dual band cellular antenna. In most cases, this antenna will provide sufficient signal strength for a successful installation.

The Honeywell Home Indoor Fixed Length Antenna should be used in installations where moving the antenna to a higher point within the building will provide a better signal strength.

Installation Note: For best signal strength, maintain at least 12 inches of clearance between the communication module and steel I-beams, HVAC ducts, metal studs, steel roofs or roofs, exterior walls with metalized insulation or aluminum siding and other large metal objects.

Kit Includes: Antenna with cable
Antenna accessory pack
Hardware

Compatible Modules: Lyric-3G, Lyric-CDMA and Lyric-3GC.

Indoor Antenna

The antenna is not weatherproof, and must be installed indoors and mounted vertically while maintaining 12 inches of clearance from large metal objects. Install the antenna as follows:

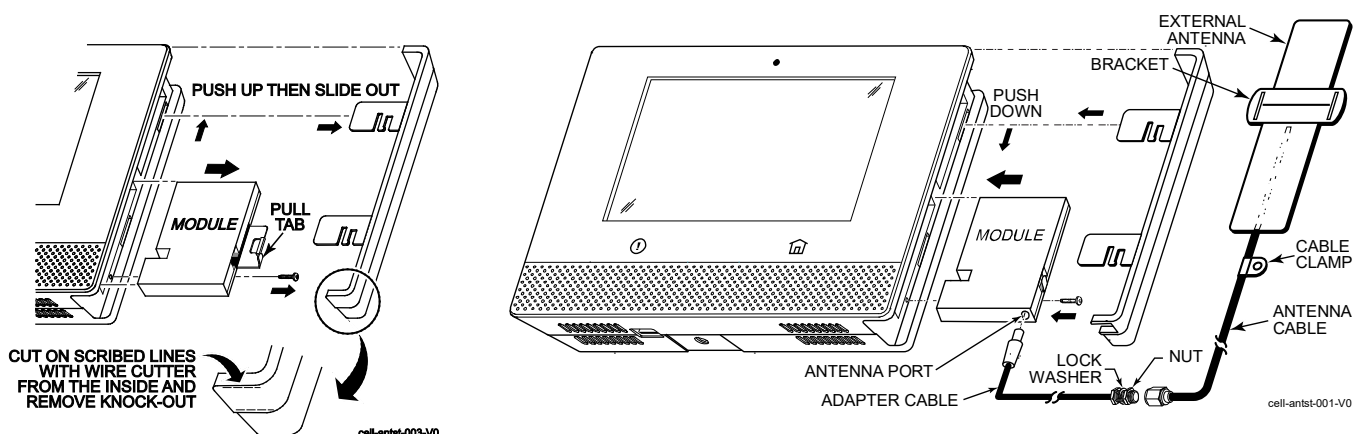

1. Find a suitable location that will allow the antenna to be mounted vertically.
2. Remove power; refer to the radio communication module installation guide for Replacing the Module.
3. Connect the short adapter cable to the antenna cable.
4. Using wire cutters, remove the knock-out area as shown below.
5. Plug the end of the adapter cable into the module's external antenna port and route the cable as shown.
6. Refer to the Cellular Information screen on the Lyric controller to make sure the displayed signal strength is adequate. See the radio communication module installation guide for specific ranges.
7. Permanently mount the antenna vertically using the included hardware.

Lyric-3G / Lyric-CDMA / Lyric-3GC Communication Module

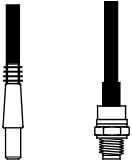

Indoor, Fixed Length Antenna Installation

Specifications

Antenna				Adapter Cable
Type	Dual band, dipole, PCB	VSWR	<2:1	SMA female to TS9 straight SMA
Bands	824-896 MHz 1850-1990 MHz	Dimensions	143 x 27 mm	
Polarization	Linear	Cover	Polyolefin, black	
Gain (Average)	1dBi	Cable Type	RG-174	
Impedance	50 Ohms	Cable Length	3m	
Input Power (Max.)	10W	Connector Type	SMA male 	

RF Exposure

Warning – The internal or external antenna(s) used with this product must be installed to provide a separation distance of at least 7.8 in. (20 cm) from all persons and must not be co-located or operating in conjunction with any other antenna or transmitter except in accordance with FCC multi-transmitter product procedures.

Mise en Garde

Exposition aux Fréquences Radio: L'antenne (s) utilisée pour cet émetteur doit être installée à une distance de séparation d'au moins 7,8 pouces (20 cm) de toutes les personnes.

IMPORTANT NOTE ABOUT EXTERNAL ANTENNAS

If an external cellular radio antenna is used, the antenna may be installed or replaced **ONLY** by a professional installer.

TO THE INSTALLER

For the communication module, the external antenna must not exceed a maximum directional gain (including cable loss) of 3.2 dBi at 850 MHz and 2.3 dBi at 1900 MHz.

The Honeywell Home Trademark is used under license from Honeywell International Inc.
This product is manufactured by Resideo Technologies, Inc. and its affiliates.



800-20802V1C 11/15 Rev. C

resideo

2 Corporate Center Drive, Suite 100
P.O. Box 9040, Melville, NY 11747
© 2020 Resideo Technologies, Inc.
www.resideo.com