

eFlow3NV Series

Power Supply/Chargers

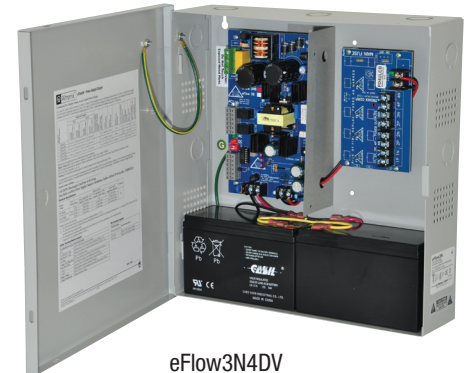

Altronix eFlow3NV series power supply/chargers convert a 220VAC (working range 198VAC - 256VAC), 50/60Hz input into a single fused or four (4) fuse/PTC protected outputs. Power supply/charger is selectable for 12VDC or 24VDC with a total of 2A max. They also offer a suite of features that includes fire alarm disconnect, overvoltage protection, and low power disconnect which prevents deep discharge of stand-by batteries.



eFlow3N4DV

Key Features

- Available with 1 or 4 outputs
- Fused or PTC protected outputs
- Additional Class 2 Rated Aux. Output rated @ 1A
- Overvoltage protection
- Fire alarm disconnect
- Supervision
 - AC Fail
 - Battery Fail and Battery Presence
 - Low power shutdown
- Built-in charger for sealed lead acid or gel type batteries
- Instantaneous transfer to stand-by batteries
- Short circuit and overload protection
- AC input and DC output LED indicators
- CE European Conformity
- Lifetime Warranty

eFlow3NV series Power Supply Configuration Reference Chart

Altronix Model Number	Input Rating: 220VAC, 50/60Hz	Input Fuse Rating	Battery Fuse Rating	Nominal DC Outputs				Maximum Supply Current for Main and Aux. Outputs (A)	Ripple Voltage (mV) Under low battery condition	Power Distribution Module	Number of Outputs	Fused Outputs Ratings	Auto-Resettable PTC Outputs Ratings	Accommodates up to 7AH Batteries	Accommodates up to 12AH Batteries
				[DC]		[AUX]									
				12VDC Output Range (V)	24VDC Output Range (V)	12VDC Output Range (V)	24VDC Output Range (V)								
eFlow3NV	2.1A	5A/250V	3A/32V	10.13-13.2	20.28-26.39	10.15-13.2	20.2-26.39	2A	960	N/A	1	-	-	✓	-
eFlow3NXV				-	-	-	✓								
eFlow3N4V	2.1A	5A/250V	3A/32V	10.13-13.2	20.28-26.39	10.15-13.2	20.2-26.39	2A	960	PD4	4	2A	-	✓	-
eFlow3NX4V				2A	-	-	✓								
eFlow3N4DV	2.1A	5A/250V	3A/32V	9.78-13.2	20.28-26.39	10.15-13.2	20.2-26.39	2A	960	PD4CB	4	-	2A	✓	-
eFlow3NX4DV				-	2A	-	✓								

Lifetime Warranty

Specifications

Input

Voltage 220VAC (working range
198VAC - 256VAC), 50/60Hz, 2.1A max.

Fusing 5A/250V

Outputs

Voltage 12VDC or 24VDC selectable
Current 2A continuous max.
Protection Fused: 2A / PTC: 2A
Auxiliary Power-limited @ 1A (unswitched)
Other Overvoltage protection. Filtered and regulated

Battery Charging

Capacity 7AH/12VDC (1 or 2 within enclosure)
12AH/12VDC (requires larger "X" enclosure)
40AH/65AH (requires separate enclosure)

Type Sealed lead acid or gel type

Fuse Rating 3A/32V

Failover Upon AC loss, instantaneous

Batteries are sold separately

Fire Alarm Disconnect

Supervised Latching or non-latching

EOL 10K Resistor

Supervision

AC Failure Form "C" contacts

Battery Form "C" contacts

Low DC Power Shutdown

Shuts down DC output terminals if battery voltage drops below 71-73% for 12V units and 70-75% for 24V units (depending on the power supply)
Prevents deep battery discharge

Indicators (LED)

Input 220VAC is present

DC Output Powered

Agency Listings

CE European Conformity

Physical and Environmental

Dimensions (H x W x D)

eFlow3NV, eFlow3N4(D)V:

Enclosure:

13.5" x 13" x 3.25" (342.9mm x 330.2mm x 82.55mm)

Shipping:

15" x 13.875" x 4.75" (381mm x 352.4mm x 120.6mm)

eFlow3NXV, eFlow3NX4(D)V:

Enclosure:

15.5" x 12" x 4.5" (393.7mm x 304.8mm x 114.3mm)

Shipping:

16.5" x 13.5" x 6" (419.1mm x 342.9mm x 152.5mm)

Weight (approx.)

Model	Product Weight	Shipping Weight
eFlow3NV	6.3 lb. (2.86 kg)	7.2 lb. (3.27 kg)
eFlow3NXV	8.15 lb. (3.7 kg)	9.1 lb. (4.13 kg)
eFlow3N4(D)V	6.45 lb. (2.93 kg)	7.35 lb. (3.33 kg)
eFlow3NX4(D)V	8.3 lb. (3.76 kg)	9.6 lb. (4.2 kg)

Temperature

Operating: 0°C to 49°C (32°F to 120°F)

Storage: -20°C to 70°C (-4°F to 158°F)

Relative Humidity

85% +/- 5%

BTU/Hr (approx.)

12VDC: 12 BTU/Hr.

24VDC: 25 BTU/Hr.

Accessories (order separately)

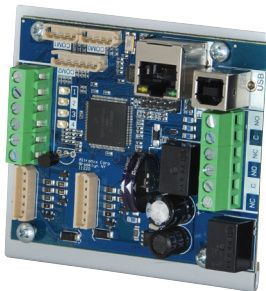

LINQ2

LINQ2 - Network Supervision

Altronix LINQ2 Network Communication Module provides remote supervision, control and monitoring over LAN/WAN

- Remotely reports accurate power diagnostics
- Controls power and resets devices
- Reports system diagnostics via Email



Lifetime Warranty

Altronix Corporation | 140 58th St | Brooklyn, NY 11220 USA

phone: +1 718.567.8181 | fax: +1 718.567.9056 | email: info@altronix.com | www.altronix.com

Dimensions and Drawing

eFlow3NV, eFlow3N4(D)V Dimensions (H x W x D approximate)

13.5" x 13" x 3.25" (342.9mm x 330.2mm x 82.55mm)

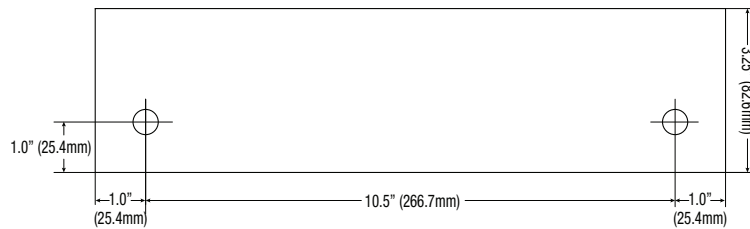
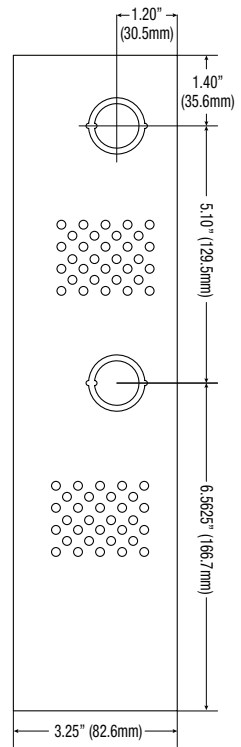
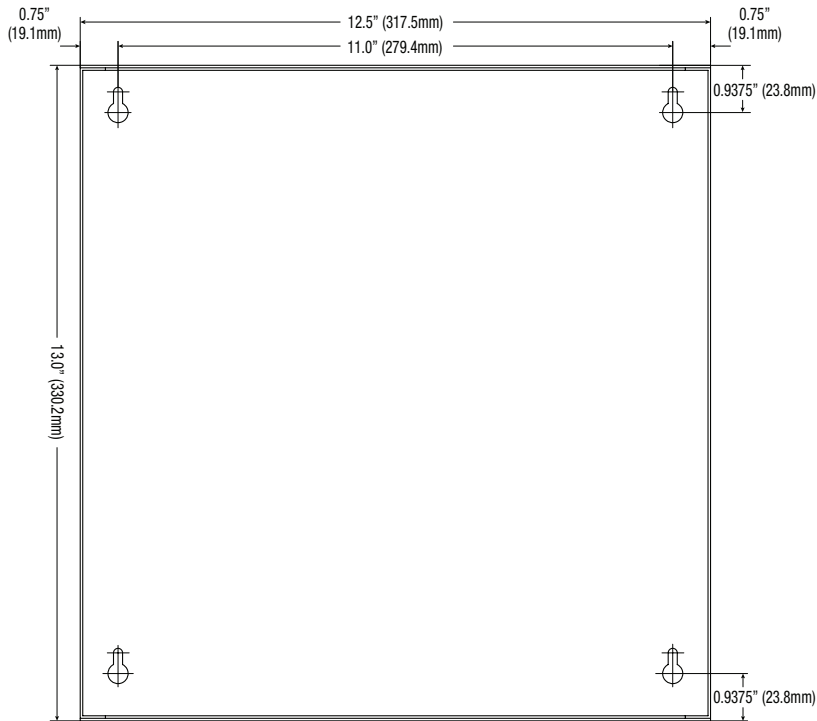
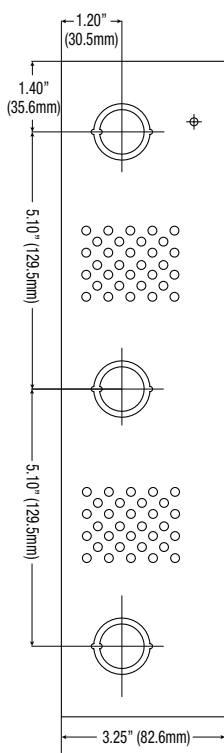
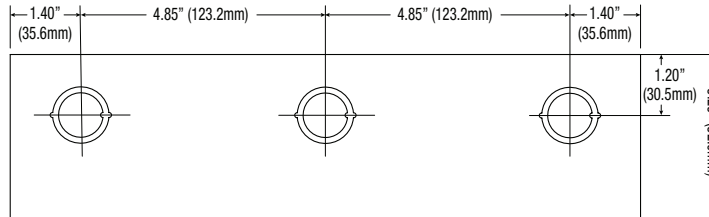

Lifetime Warranty

Altronix Corporation | 140 58th St | Brooklyn, NY 11220 USA

phone: +1 718.567.8181 | fax: +1 718.567.9056 | email: info@altronix.com | www.altronix.com

Dimensions and Drawing

eFlow3NXV, eFlow3NX4(D)V Dimensions (H x W x D approximate)

15.5" x 12" x 4.5" (393.7mm x 304.8mm x 114.3mm)

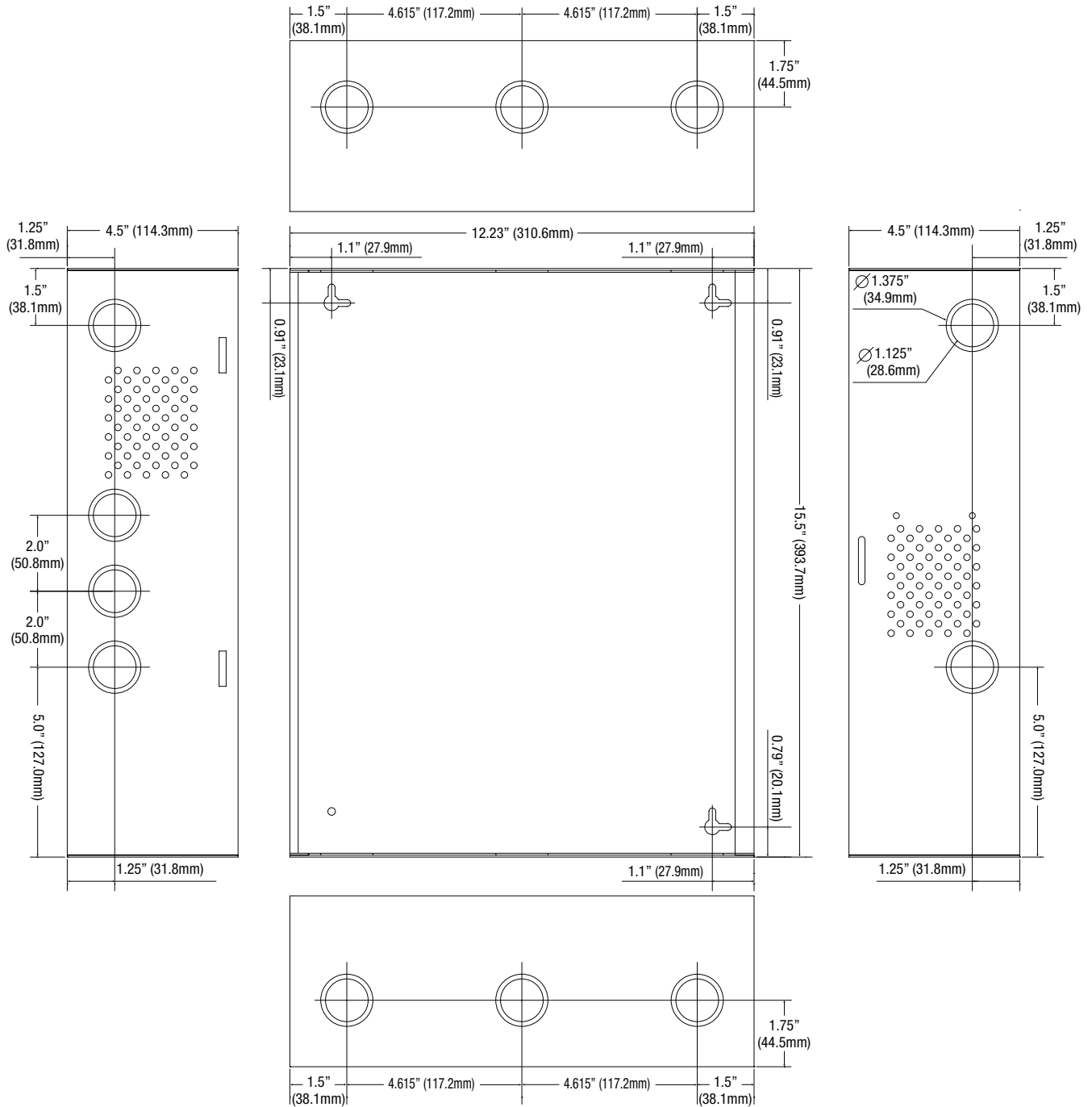

Lifetime Warranty

Altronix Corporation | 140 58th St | Brooklyn, NY 11220 USA

phone: +1 718.567.8181 | fax: +1 718.567.9056 | email: info@altronix.com | www.altronix.com