

Access & Power Integration

Altronix/Mercury Wired Kits

Models Include:

16 Door Kits with Fused Outputs:

T3M77LCK1

Accommodates one (1) Intelligent Dual Reader Controller and seven (7) Dual Reader Interface Modules.

14 Door Kits with Fused Outputs:

T3M77LCK2

Accommodates one (1) Intelligent Controller and seven (7) Dual Reader Interface Modules.

16 Door Kits with Fused Outputs:

T3M77LCK3

Accommodates up to eight (8) Dual Reader Interface Modules.

Each fully assembled kit includes:

- Trove3 enclosure with TM3 Altronix/Mercury backplane
- Two (2) AL1024ULXB2 - Power Supply/Charger
- Two (2) ACMS8 - Dual Input/Output Fuse Protected Access Power Controller
- Two (2) VR6 - Voltage Regulator
- Two (2) PDS8 - Dual Input/Output Fuse Protected Power Distribution Module
- One (1) Rocker Switch Bracket with Two (2) Rocker Switches (Not evaluated by UL)
- Wire harnesses and management

16 Door Kits with PTC Outputs:

T3M77LCK1D

Accommodates one (1) Intelligent Dual Reader Controller and seven (7) Dual Reader Interface Modules.

14 Door Kits with PTC Outputs:

T3M77LCK2D

Accommodates one (1) Intelligent Controller and seven (7) Dual Reader Interface Modules.

16 Door Kits with PTC Outputs:

T3M77LCK3D

Accommodates up to eight (8) Dual Reader Interface Modules.

Each fully assembled kit includes:

- Trove3 enclosure with TM3 Altronix/Mercury backplane
- Two (2) AL1024ULXB2 - Power Supply/Charger
- Two (2) ACMS8CB - Dual Input/Output PTC Protected Access Power Controller
- Two (2) VR6 - Voltage Regulator
- Two (2) PDS8CB - Dual Input/Output PTC Protected Power Distribution Module
- One (1) Rocker Switch Bracket with Two (2) Rocker Switches (Not evaluated by UL)
- Wire harnesses and management

Installation Guide

All components of this Trove kit are UL Listed sub-assemblies.

Please refer to the included corresponding Sub-Assembly Installation Guides for further information.



All registered trademarks are property of their respective owners.



More than just power.™

Rev. T3M77LCK050622

Installing Company: _____ Service Rep. Name: _____

Address: _____ Phone #: _____

Overview:

Altronix Trove Plus kits are pre-wired, pre-assembled and consist of Trove3M3 enclosure/backplane with factory installed Altronix power supply/charger(s) and sub-assemblies, wire harnesses and finger duct.

Configuration Chart:

Altronix Model Number	115VAC 60Hz Input Current (A)	Power Supply Board Input Fuse Rating	Power Supply Board Battery Fuse Rating	Nominal DC Output Voltage		Maximum Supply Current for Main Outputs on Power Supply boards and ACMS8(CB) Access Power Controller's outputs	Fail-Safe/Fail-Secure or Dry Form "C" Outputs	Current Per ACMS8 and PDS8(CB) Output (A)	ACMS8(CB) Board Input Fuse (PTC) Rating	ACMS8(CB) Board Output Fuse (PTC) Rating	PDS8(CB) Board Input Fuse (PTC) Rating	PDS8(CB) Board Output Fuse (PTC) Rating
				Power Supply 1	Power Supply 2							
T3M77LCK1	8.4	5A/ 250V	15A/ 32V	20.17- 26.4	20.17- 26.4	24VDC @ 9.4A	16	2.5	15A/ 32V	3A/ 32V	10A/ 32V	3A/ 32V
T3M77LCK2												
T3M77LCK3												
T3M77LCK1D								2.0	9A	2.5A	9A	2.5A
T3M77LCK2D												
T3M77LCK3D												

Hardware and Accessories:

- Two (2) tamper switches (Altronix Model TS112 or equivalent).
- Cam lock.
- Battery leads.

Mechanical:

- 16 Gauge enclosure with ample knockouts for convenient access.
- Enclosure Dimensions (H x W x D): 36.12" x 30.125" x 7.06" (917.5mm x 768.1mm x 179.3mm).

Installation Instructions:

Wiring methods shall be in accordance with the National Electrical Code/NFPA 70/ANSI, and with all local codes and authorities having jurisdiction. Product is intended for indoor use only.

1. Remove backplane from enclosure. Do not discard hardware.
2. Mark and predrill holes in the wall to line up with the top three keyholes in the enclosure. Install three upper fasteners and screws in the wall with the screw heads protruding. Place the enclosure's upper keyholes over the three upper screws, level and secure. Mark the position of the lower three holes. Remove the enclosure. Drill the lower holes and install the three fasteners. Place the enclosure's upper keyholes over the three upper screws. Install the three lower screws and make sure to tighten all screws.
3. Mount included UL Listed tamper switches (Altronix Model TS112 or equivalent) in desired location, opposite hinge. Slide the tamper switch bracket onto the edge of the enclosure approximately 2" from the right side (*Fig. 1, pg. 2*). Connect tamper switch wiring to the Access Control Panel input or the appropriate UL Listed reporting device. To activate alarm signal open the door of the enclosure.
4. Mount Mercury boards to backplane, refer to *pg. 3, 4*.
5. Refer to the *ULXB Power Supply/Charger Installation Guide* for AL1024ULXB2 and corresponding *Sub-Assembly Installation Guides* for PDS8(CB) and ACMS8(CB) for further installation instructions.
6. Position Lenel/Mercury access controller module over corresponding spacers and depress onto snap on spacers (*Fig. 2-4, pg. 3-5*).
7. Mount backplane to enclosure with hardware.

Fig. 1

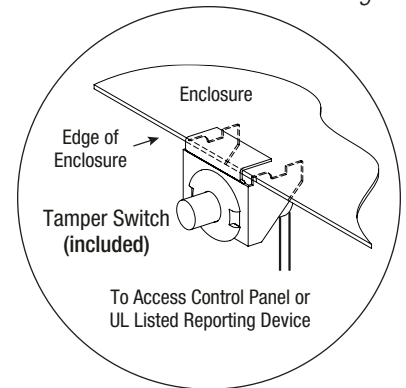

T3M77LCK1 (T3M77LCK1D) Configuration:

1. Position access controller module over corresponding spacers and depress onto snap on spacers (Fig. 2, pg. 3).
2. Mount backplane to enclosure with hardware.

Access Controller Position Chart for the Following Models:

LenelS2 / Mercury Access Controller	Pem Mounting
LNL-2220 / LP1502 / LP4502	(A)
LNL-1320 / MR52	(B) (C) (D) (E) (F) (G) (H)

Fig. 2

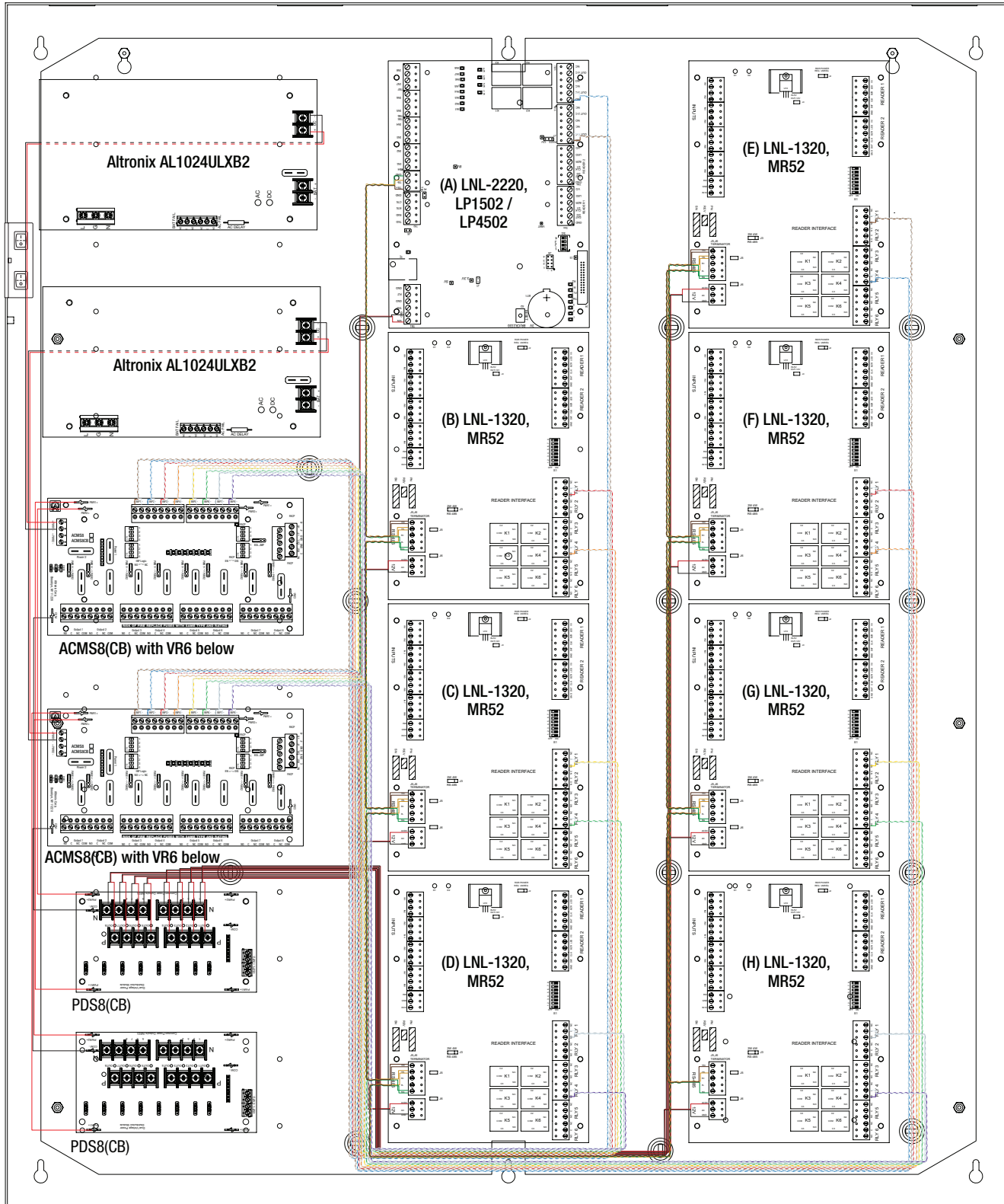

T3M77LCK2 (T3M77LCK2D) Configuration:

1. Position access controller module over corresponding spacers and depress onto snap on spacers (Fig. 3, pg. 4).
2. Mount backplane to enclosure with hardware.

Access Controller Position Chart for the Following Models:

LenelS2 / Mercury Access Controller	Pem Mounting
LNL-3300 / LP2500	(A)
LNL-1320 / MR52	(B) (C) (D) (E) (F) (G) (H)

Fig. 3

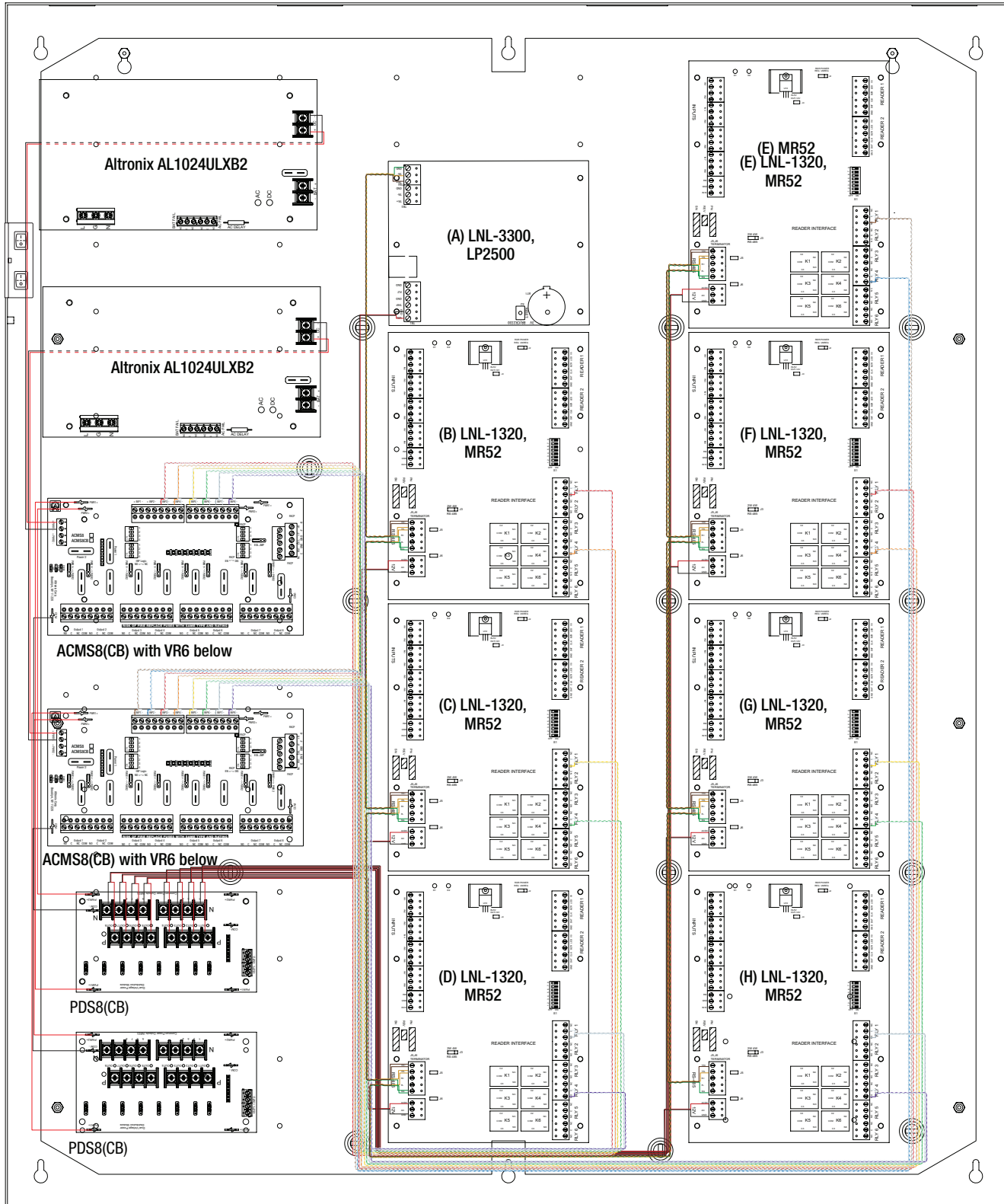

T3M77LCK3 (T3M77LCK3D) Configuration:

1. Position access controller module over corresponding spacers and depress onto snap on spacers (Fig. 4, pg. 5).
2. Mount backplane to enclosure with hardware.

Access Controller Position Chart for the Following Models:

LenelS2 / Mercury Access Controller	Pem Mounting
LNL-1320 / MR52	(A) (B) (C) (D) (E) (F) (G)

Fig. 4

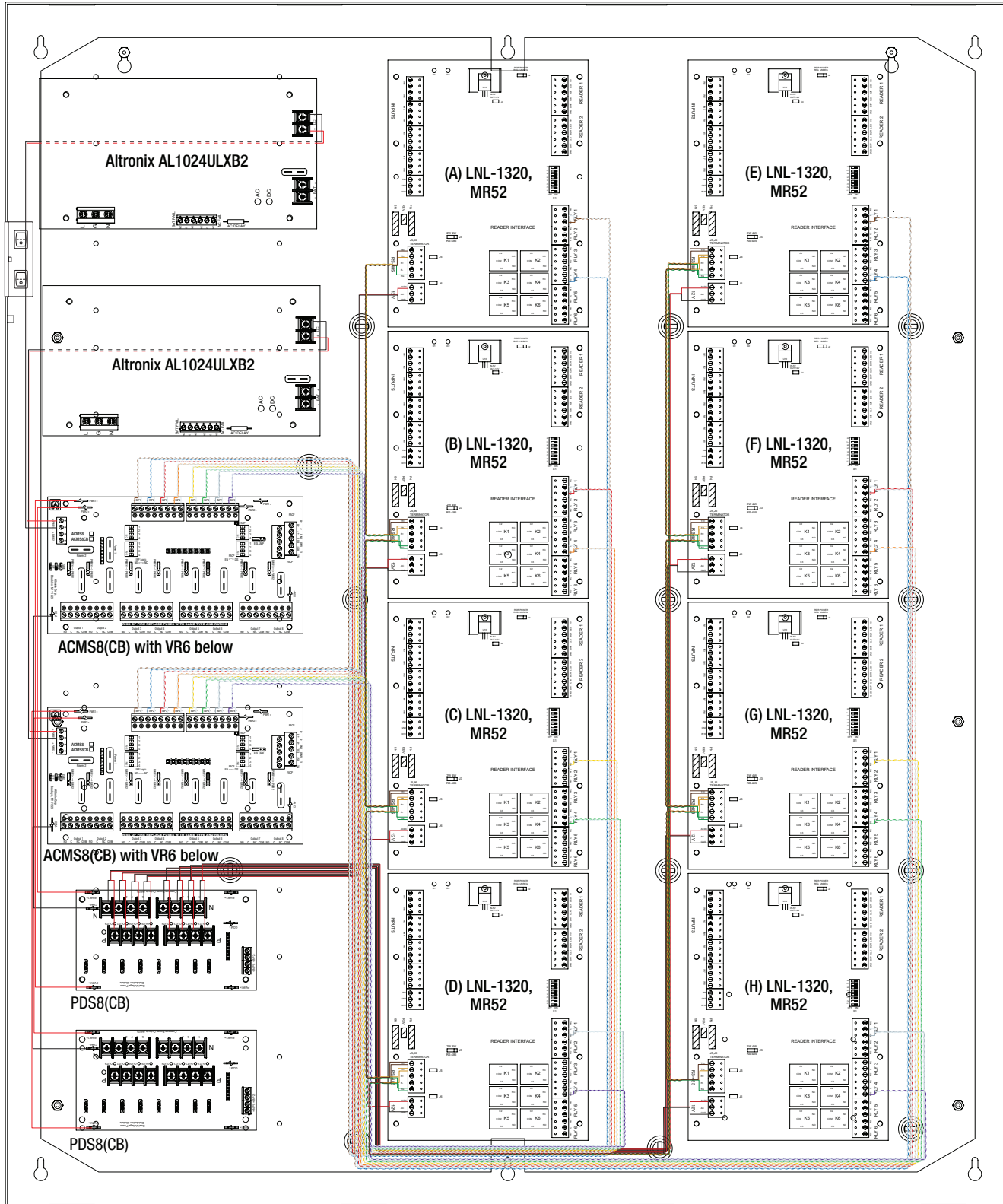

Notes:

34" x 28" x 0.3125" (863.6mm x 711.2mm x 7.9mm)

34" x 28" x 0.3125" (863.6mm x 711.2mm x 7.9mm)

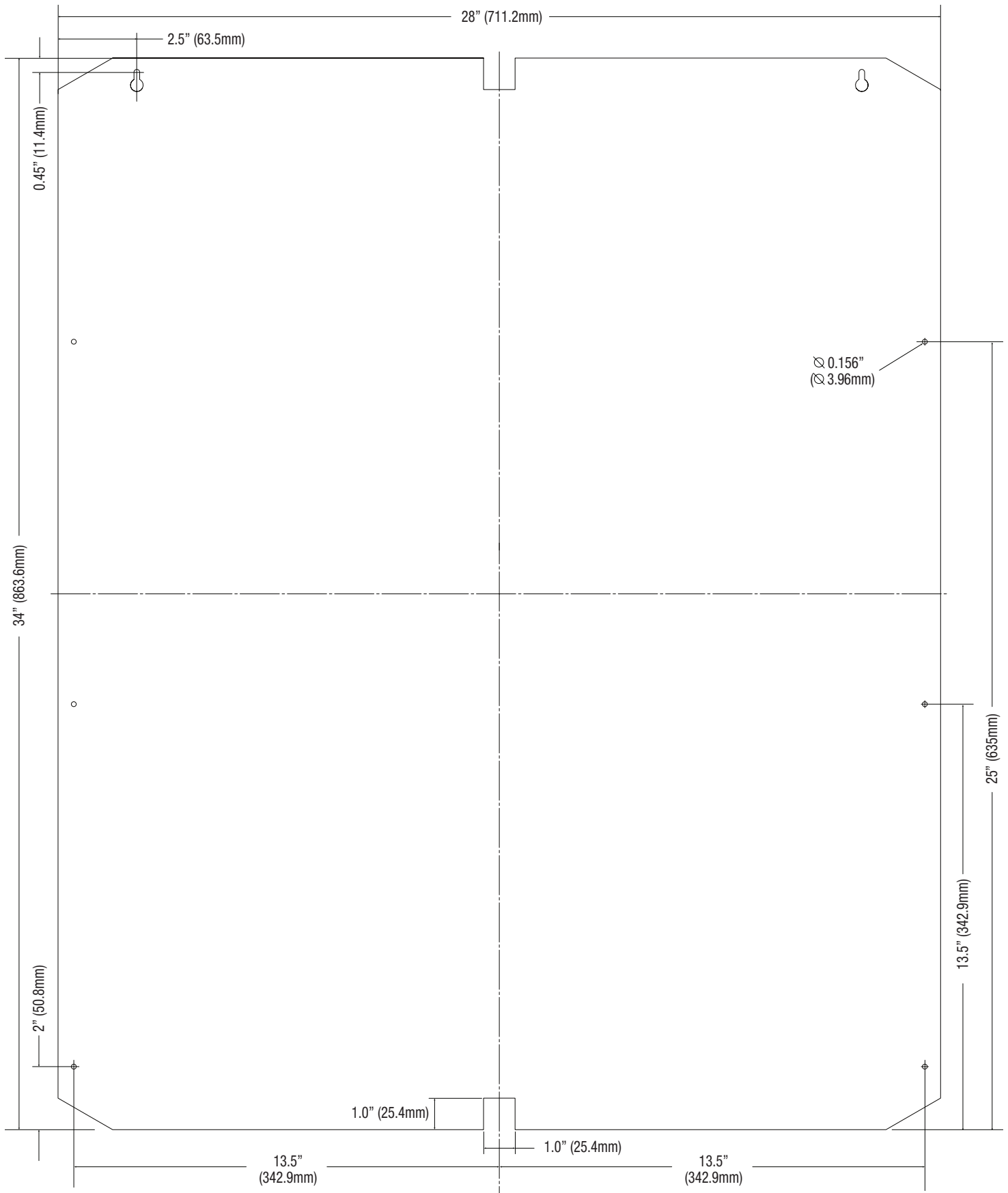

36.12" x 30.125" x 7.06" (917.5mm x 768.1mm x 179.3mm)

