



The 8000 Series is also available in a **Complete One Box Solution**

# 8000 Series

## The concealed electric strike solution for cylindrical locksets

*Shown with 801 Option*

The 8000 series is a compact, high performance electric strike featuring a unique concealed design for use with cylindrical locksets. No cutting on the frame is required. Simply remove the existing strike plate, adjust the vertical alignment feature to the latchbolt centerline, and install. Its strength is derived from a unique keeper pin locking design, enabling the 8000 to exceed the ratings of the frame, door and locking hardware. This field selectable fail secure/fail safe unit is easy to install and accommodates latchbolts up to 5/8" throw.



### Specifications

- UL 1034, burglary-resistant listed and suitable for outdoor use
- UL 294 (6th Edition) listed
- ANSI/BHMA A156.31, Grade 1
- RoHS compliant
- Patents: 5,934,720; 8,146,966; 8,157,302; 8,465,067

### Frame Application

- Metal
- Wood

### Electrical

- .24 Amps at 12 VDC/VAC
- .12 Amps at 24 VDC/VAC
- DC continuous duty/ AC intermittent duty only
- PoE friendly

## 8000 Models

<b>8000</b>	Universal electric strike	Faceplate options ordered separately, see page 38
<b>8000C</b>	Complete electric strike	Includes the 801 and 801A faceplates
<b>RF8010</b>	Integrated Prox	Includes the strike body, Prox reader and door position switch
<b>IC8020</b>	Integrated iCLASS®	Includes the strike body, iCLASS reader and door position switch

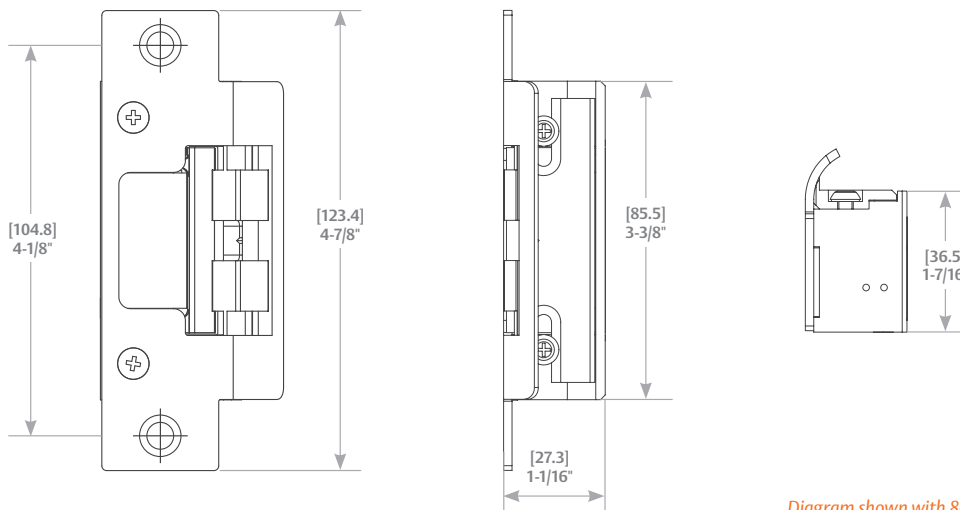

Diagram shown with 801 Option

### Standard Features

- No cutting on frame required
- Vertical adjustability to accommodate door sag and misalignment
- Tamper-resistant
- Static strength 1,500 lbs.
- Dynamic strength 70 ft-lbs.
- Endurance 500,000 cycles
- Field selectable fail secure/fail safe
- Dual-voltage 12 or 24 VDC/VAC
- Non-handed
- Internally mounted solenoid
- Accommodates 1/2" – 5/8" cylindrical latchbolt (5/8" with 1/8" door gap)

- Strike body depth 1-1/16"
- Strike body width 1-7/16"
- Five-year limited warranty

### Optional Features

**LBM** » Latchbolt monitor

### Accessories

**2001M** » Plug-in bridge rectifier

**2004M** » ElectroLynx® adapter

**2005M3** » SMART Pac® III

**2006M** » Plug-in buzzer

### Finishes

**630** » Satin stainless

**605** » Bright brass

**606** » Satin brass

**612** » Satin bronze

**613** » Bronze toned

**629** » Bright stainless steel

**BLK** » Black

*\*Complete Pacs are only available in the 630 finish*



CYLINDRICAL  
LOCKSETS



FIELD SELECTABLE  
(12 OR 24VDC)



FIELD SELECTABLE  
(FAIL SECURE/  
FAIL SAFE)



GRADE 1



OUTDOOR  
RATED



UL 1034  
BURGLARY  
LISTED

